

2007 - 2008 OFFICERS

CHAIR

David Miller, NatureWorks LLC
Phone: (402) 533-1410
Email: millerd7@asme.org

VICE CHAIR / NEWSLETTER

Gary Ruhl, OPPD.
Phone: (402) 636-2673
Email: gruhl@oppd.com

SECRETARY / PROF. DEVELOPMENT CHAIR

Robert L. Bowman, MUD
Phone: (402) 504-7923
Email: Bob_Bowman@mudnebr.com

TREASURER / MEMBER & INTEREST

Mark Loscutoff, Auto. Concepts
Phone: (712) 388-6348
Email: mloscutoff@automatedconcepts.com

PROGRAMS / TECHNICAL ACTIVITIES CHAIR

Matt Dick, RSI Materials Engr.
Phone: (402) 827-5712
Email: matt@rsime.com

MEMBERSHIP DEVELOPMENT / HONORS & AWARDS CHAIR

Matt Walker, Engineered Controls
Phone: (402) 434-2110
Email: mwalker@engineeredcontrols.com

SCHOLARSHIP / COLLEGE RELATIONS CHAIR

Gary Ruhl (09), OPPD
Phone: (402) 636-2673
Email: gruhl@oppd.com

HISTORY & HERITAGE / GOVERNMENT RELATIONS CHAIR

Bill Redinger, OPPD
Phone: (402) 636-2482
Email: wredinger@oppd.com

WEBMASTER

Greg Krieser, OPPD
Phone: (402) 636-2603
Email: krieserq@asme.org

FACULTY ADVISORS

UNIV. OF NEBRASKA - LINCOLN

Wieslaw Szydowski
Phone: (402) 472-5969
Email: merdwms@engunx.unl.edu

SOUTH DAKOTA STATE UNIV.

Fereidoon Delfanian, P.E.
Phone: (605) 688-4300
Email: fereidoon.delfanian@sdstate.edu

S. DAKOTA SCHOOL OF MINES & TECHNOLOGY

Dr. Karim Muci
Phone: (605) 394-6885
Email: karim.muci@sdsmt.edu

DORDT COLLEGE

Nolan Van Gaalen
Phone: (712) 722-6289/1198
Email: nolan@dordt.edu

ASME International

Three Park Avenue
New York, NY 10016-5990

ASME UNIT SUPPORT

1-800-843-2763

September 2007 Newsletter

Message from the Chair

Hello and welcome to another year of the Nebraska Section of ASME. My name is David Miller and I am the section chair for the coming 2007-2008 year. I am excited about the events of this upcoming year and I hope you will be able to participate in the various tours, courses, and social events we have planned over the next year.

Please welcome and congratulate our incoming committee members, Robert Bowman, Matt Dick, and Matt Walker. New faces continue to provide fresh perspective in the programs and activities we provide.

I would like to extend a sincere **THANK YOU** to the outgoing executive committee members, Chad Ballain, outgoing treasurer, and Susan Randall, outgoing chair. They have left the Nebraska section executive committee as one of the strongest and most active sections in the nation. They will be a tough act to follow.

We continue to refine the activity schedule for the coming year. We are going to continue to offer a fall PE refresher course, details of which you should have received in an earlier email; a flyer is also included herein. The September meeting will be held **September 16th at the University of Nebraska Tractor Test Facility** on the East Campus in Lincoln, a flyer for that meeting is also included. We are planning on going to Great Dane Trailers in Wayne, Nebraska in October. There will be a fall professional development course in November. December will bring the traditional family event of dinner and theatre at Mahoney State Park. Our tentative schedule is published in this newsletter.

We strive to offer our membership activities that are interesting, educational, and most of all, worthwhile. Our purpose is to advance the interests and be the public face of mechanical engineers. If you have an idea for a tour, professional development course, or activity please feel free to let us know. Please feel free to contact me at millerd7@asme.org.

Sincerely,

David K. Miller
ASME, Nebraska Section Chair.

2007 ASME Nebraska Section planned program is as follows:

September 16th - UNL Tractor Lab Tour (flyer attached)
Sept 5th to Oct 17th - PE Refresher Course (flyer attached)
October – Great Dane Tour
November – PD Course; RSI Tour
December – Mahoney Christmas Play
January – Speaker/Social Event
February – ASHRAE Joint Luncheon; E-Week Banquet
March – PD Course
April – Case New Holland Tour
May – OPPD Neb City 2 Tour or MUD Treatment Facility
June – NSPF Golf Outing; OPPD Power Drive Competition

ASME September Meeting

“NEBRASKA TRACTOR TEST LABORATORY”

Wednesday, September 26, 2007
6:00 PM

Nebraska Tractor Test Laboratory
35 & East Campus Loop
P.O. Box 830832
Lincoln, NE 68583-0832

The University of Nebraska Tractor Test Laboratory is the officially designated tractor testing station for the United States and tests tractors according to the codes of the Organization for Economic Cooperation and Development ([OECD](#)). Twenty-nine countries adhere to the tractor test codes (including non-OECD members: China, India, the Russian Federation, and Serbia), with active tractor test stations in approximately 25 of those countries. The Director of the Facility, Roger Hoy and his staff will be giving a tour of the laboratory and the Lester F. Larson Tractor Test and Power Museum.

Dinner at Valentino's (35th & Holdrege) following, Buffet \$12.00. Students \$6.00.

Directions

From I-80 East: Take exit 409 (Waverly), turn left on highway 6 (Cornhusker highway). Proceed west about 5 miles to 33rd Street. Turn left and head south 4-5 blocks and turn left on East Campus Loop. Enter second driveway on the right.

From I-80 West: Take exit 403 (North 27th St), go south on 27th about 2.5 miles, turn left on Cornhusker highway. Go east to 33rd street (6 blocks), and turn right and go 4-5 blocks south. Turn left on East Campus Loop and enter second driveway on the right.

Registration Information

Please contact David Miller at dave_miller@natureworksllc.com or 402-533-1410.

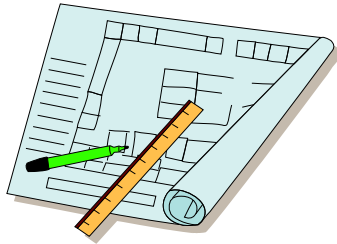

ASME Refresher Course for the Professional Engineers Exam

Starting in September, the Nebraska Section of ASME will be hosting 6 classes for individuals interested in reviewing instructional materials for the Professional Engineers Exam. There is no cost for the course or materials. This course starts on September 5th and continues weekly through October 17th.

Please reserve your spot in the class by August 31st by calling Frank Pruitt at Utility Engineering's Omaha office at 548-4869 during the day or by e-mail at frank.pruitt@ue-corp.com. Be sure to include your phone number and e-mail address where you want course materials sent (or mailing address if you wish to receive a hard copy).

Course & Schedule:

This is the tentative list of subjects and schedule (any changes will be formally announced the first night). All classes are from 7:00 to 9:00 pm.

<u>Class</u>	<u>Date</u>	<u>Instructor</u>		
Thermodynamics	Wednesday, Sept. 5	David Rohan	HDR, Inc.	926-7119
Fluid Mechanics	Wednesday, Sept. 12	Brian Erbstoesser	Design & Constr. Engr.	384-8900
HVAC	Wednesday, Sept. 19	Ron Feuerbach	Morrissey Engr.	491-4144
Heat Transfer	Wednesday, Sept. 26	Jim Boucher	Tenaska	691-9500
Engineering Economics	Wednesday, Oct. 3	Kurt Maack	NNGC	398-7871
Machine Design	Wednesday, Oct. 10	Wieslaw Szydlowski	UN – Lincoln	472-5969
(Make-Up Date)	Wednesday, Oct. 17			

Professional Engineers Exam: Friday, Oct. 26, 2007

Course Materials:

Course materials will be distributed approximately one week prior to each class. Materials will be e-mailed in Adobe “.pdf” format unless a hard copy is specifically requested.

Location:

HDR Engineering, Inc.
 Omaha office
 8404 Indian Hills Drive
 (one block south of Dodge at 84th Street)

When you arrive at HDR, please park on the north side of the building in the west lot. Enter through the glass double doors. Since this is a secured building, someone will assist you in where you need to go for class.





The ASME Foundation would like to thank all staff and membership for your generosity in the efforts to establish the ASME - Virginia Tech Scholarship Fund. The Scholarship Fund will forever remember the victims of this tragedy and honor the survivors through yearly awards to deserving graduate students of the School of Mechanical Engineering.

Our commitment to match the initial \$25,000 gift to the fund from ASME prompts The Foundation to extend this appeal until the one-year anniversary of the events in April 2008. Those who have already contributed can do so again, perhaps in honor of a loved one or to substantiate your enthusiasm and philanthropy toward a worthy cause. Similarly, we give those of you who might not have donated a chance to be a part of a lasting legacy that has turned this tragedy into an event to reflect upon with hope and resilience for the future.

Many student members of ASME have inquired of ways to contribute to the scholarship fund via on-campus fundraising events. Whether you are with a student section or a professional level section, you can help make a big difference in our commitment to Virginia Tech by raising money in your section's name. Please feel free to contact us at fundraising@asme.org to discuss how you might do that. We encourage such efforts and want to know more about the varying methods you devise to encourage donation to the ASME/VT Memorial Scholarship fund. Thank you for your generosity!

Renew ASME Membership Early for Your Chance to Win a 42" Plasma TV!

Find out how you could become eligible to win a 42" Plasma TV simply by renewing your ASME membership by Sept. 1 (for 2 entries to win) or renew online by Oct. 1 and receive three entries. All paid renewals must be received on or before Oct. 1. For more details visit http://www.asme.org/Membership/ReferMember/Renew_Early_Win_42_Plasma_TV.cfm or call ASME Infocentral at 1-800-843-2763.

Advancing Your Career With ASME PPC

The ASME Professional Practice Curriculum (PPC) is an online resource designed to help you advance in the engineering profession by providing guidance and resources on subjects that complement an engineers technical skills.

The PPC consists of 42 modules on topics ranging from product development and writing cost proposals to team building and negotiation. The PPC also provides information on alternative engineering career paths such as patent law, marketing and sales, and entrepreneurship.

To get started, please visit