

2008 - 2009 OFFICERS

CHAIR

Gary Ruhl, OPPD
Phone: (402) 636-2673
Email: gruhl@oppd.com

VICE CHAIR / NEWSLETTER

Mike Carlson, Zachry Eng.
Phone: (402) 548-4807
Email: mike.carlson@ue-corp.com

SECRETARY / PROF. DEVELOPMENT

Robert L. Bowman, MUD
Phone: (402) 504-7923
Email: Bob_Bowman@mudnebr.com

TREASURER / MEMBER & INTEREST

Dave Stransky
Phone: (402) 399-1258
Email: david.stransky@hdrinc.com

PROGRAMS / TECHNICAL ACTIVITIES

Hans Iwand, Rail Sciences
Phone: (402) 827-9328
Email: hans@railsciences.com

MEMBERSHIP DEVELOPMENT

HONORS & AWARDS
Bill Madden,
Phone: (402)
Email: kis91321@yahoo.com

SCHOLARSHIP / COLLEGE RELATIONS

Gary Ruhl, OPPD
Phone: (402) 636-2673
Email: gruhl@oppd.com

**HISTORY & HERITAGE
GOVERNMENT RELATIONS**

Bill Redinger, OPPD
Phone: (402) 636-2482
Email: wredinger@oppd.com

WEBMASTER

Greg Krieser, OPPD
Phone: (402) 636-2603
Email: krieserq@asme.org

FACULTY ADVISORS

UNIV. OF NEBRASKA - LINCOLN

Wieslaw Szydowski
Phone: (402) 472-5969
Email: merdwms@engunx.unl.edu

SOUTH DAKOTA STATE UNIV.

Fereidoon Delfanian, P.E.
Phone: (605) 688-4300
Email: fereidoon.delfanian@sdstate.edu

**S. DAKOTA SCHOOL OF MINES
& TECHNOLOGY**

Dr. Karim Muci
Phone: (605) 394-6885
Email: karim.muci@sdsmt.edu

DORDT COLLEGE

Nolan Van Gaalen
Phone: (712) 722-6289/1198
Email: nolan@dordt.edu

ASME International
Three Park Avenue
New York, NY 10016-5990

ASME UNIT SUPPORT
1-800-843-2763

September 2008 Newsletter

Message from the Chair

Another year has passed and we are looking forward to a great year for the Nebraska Section of ASME. My name is Gary Ruhl and I am the section chair for the coming 2008-2009 year. There are many nice events planned for this year and I hope you take the time from your busy schedules to join us at the various tours, courses, and socials.

Please welcome and congratulate our incoming committee members, Hans Iwand, Bill Madden, Dave Stransky, and Mike Carlson. New faces continue to provide fresh perspective in the programs and activities we provide.

I would like to extend a sincere **THANK YOU** to the outgoing executive committee members, Mark Loscutoff, outgoing treasurer, Matt Dick, outgoing programs chair, and Matt Walker, outgoing honors and awards chair. These volunteers keep our Nebraska section as one of the strongest and most active sections in the nation.

We continue to refine the activity schedule for the coming year. We are going to continue to offer a fall **PE refresher course which starts September 3rd**, details of which you should have received in an earlier email; a flyer is also included herein. The September meeting will a tour of **3M in Valley, NE on September 16th**. A flyer for that meeting is also included. We are planning a total of 5 industry tours this year. There will also be professional development courses in November and March. December will bring the traditional family event of dinner and theatre at Mahoney State Park. Our tentative schedule is published in this newsletter.

We strive to offer our membership activities that are interesting, educational, and most of all, worthwhile. Our purpose is to advance the interests and be the public face of mechanical engineers. If you have an idea for a tour, professional development course, or activity please feel free to let us know. Please forward your ideas to gruhl@oppd.com.

Sincerely,

Gary Ruhl
ASME, Nebraska Section Chair.

2008 ASME Nebraska Section planned program is as follows:

September 16th – 3M Tour (flyer attached)
Sept 3rd to Oct 15th - PE Refresher Course (flyer attached)
October – Victory Motorcycle or Wells Blue Bunny??
November – PD Course
December – Mahoney Christmas Play
January – Duncan Aviation tour or Speaker/Social Event
February – ASHRAE Joint Luncheon; E-Week Banquet
March – PD Course
April – Becton Dickenson Tour, Columbus, NE
May – Magnus Farley Tour, Fremont, NE
June – NSPE Golf Outing; OPPD Power Drive Competition

ASME September Meeting

3M, Valley, NE

Tuesday, September 16, 2007
5:30 PM

3M
600 E. Meigs St.
Valley, NE 68064
RSVP Required, see below.

3M Valley is managed by the 3M Occupational Health and Environmental Safety Division (OH&ESD) which makes up 80 percent of the annual volume of the plant in the production of respirators, welding helmets, filters, carbon cartridges, sorbent pads and booms, and insulation. The Medical Division makes up 15 percent of the plant volume with patient plates and EKG electrodes. Construction and Home Improvement Markets Division (respirators) and Consumer Health Care (First Aid Dressings) comprise the remainder of the plant volume.

Dinner to follow at Farmer Browns 2620 River Road Dr., Waterloo, NE. Dinner choices will be Club Steak, Roast Prime Rib, Country Style BBQ Ribs, Orange Roughy, or Salmon Filet. Prices: \$20 member, \$10 for student and retirees. Cash or check accepted.

Directions

From Omaha: Take Dodge, Maple, or Center street West to HWY 275 west towards Fremont. Take the Meigs street exit (look for the Dairy Queen on your right). Turn left onto Meigs, continue over the railroad viaduct approximate 1 mile, the 3M plant will be on your right, before the first stop sign. Turn into the south parking lot along Meigs street. Drive time is 15 minutes from Westroads.

From Lincoln: Take HWY 77 north through Wahoo, take HWY 92 west through Yutan towards Omaha. Approximately 2 miles after crossing the Platte River, turn north on 264th Street (at the corner of Venice Antiques). Continue north approximately 5 miles, to the intersection of 264th and Meigs. Turn left onto Meigs, continue ¼ mile, 3M will be on your right. Turn into the south parking lot along Meigs Street. Drive time is approximately 50 minutes from HWY 77 and Cornhusker road in Lincoln.

To Farmer Browns: Maps will available at the 3M tour.

Registration Information

RSVP REQUIRED: Please contact Mike Carlson at 402-548-4807 or by e-mail at mike.carlson@ue-corp.com. RSVP must include your full name and company/employer name. RSVP must be received no later than September 5, 2008.

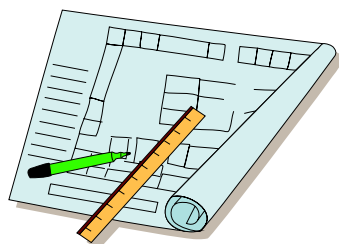

ASME Refresher Course for the Professional Engineers Exam

Starting in September, the Nebraska Section of ASME will be hosting 6 classes for individuals interested in reviewing instructional materials for the Professional Engineers Exam. For those looking to renew their license, CEU credits can be provided. There is no cost for the course or materials, and you do not have to be an ASME member. This course starts on September 3rd and continues weekly through October 15th.

Please reserve your spot in the class by calling Dave Stransky at HDR's Omaha office at 399-1258 during the day or by e-mail at david.stransky@hdrinc.com. Be sure to include your phone number and an e-mail address where you want course materials sent (or mailing address if you need a printed copy).

Course & Schedule:

This is the tentative list of subjects and schedule (any changes will be formally announced the first night). All classes are from 7:00 to 9:00 pm.

Class	Date	Instructor
Thermodynamics	Wednesday, Sept. 3	David Rohan HDR, Inc. 926-7119
Fluid Mechanics	Wednesday, Sept. 10	Brian Erbstoesser Dsn & Constr. Engrs 384-8900
Heat Transfer	Wednesday, Sept. 17	Jim Boucher Tenaska 691-9500
Engineering Economics	Wednesday, Sept. 24	Kurt Maack NNGC 398-7871
HVAC	Wednesday, Oct. 1	Ron Feuerbach Morrissey Engr. 491-4144
Machine Design	Wednesday, Oct. 8	Wieslaw Szydowski UN – Lincoln 472-5969
(Make-Up Date)	Wednesday, Oct. 15	

Professional Engineers Exam: Friday, Oct. 24, 2008

Course Materials:

Course materials will be distributed approximately one week prior to each class. Materials will be e-mailed in Adobe “.pdf” format unless a hard copy is specifically requested.

Location:

HDR Engineering, Inc.
 Omaha office
 8404 Indian Hills Drive
 (one block south of Dodge at 84th Street)

When you arrive at HDR, please park on the north side of the building in the west lot. Enter through the glass double doors. Since this is a secured building, someone will assist you in where you need to go for class.



Awards and Recognition



Congratulations to Professor Nolan Van Gaalen of the Engineering Department at Dordt College, who was honored by being nominated by District C for the 2008 Student Section Award. Professor Van Gaalen was awarded a certificate, a plaque, and a \$500 honorarium in recognition for his continued outstanding leadership and service to his students and to ASME. This recognition was funded by a contribution made to the ASME Foundation from Lynden Davis, ASME District Leader D. Professor Van Gaalen's nomination was submitted by former section chair, Susan Randall. Please thank Professor Van Gaalen and all the student section advisors for their continued support of ASME!

REMINDER:

ASME Membership for 2008-2009 renewals are due Oct 1, 2008. You can renew online at <https://shop.asme.org/DuesRenewel.cfm>, or can return your dues by mail. Renewing early will earn you a chance to win a 42" plasma TV!!

Call for Mentors

Calling all mechanical engineers who would like to:

- Influence the career and academic choices of student engineers
- Help early career engineers find their way in the profession
- Contribute to the future of mechanical engineering

How can you do all these things, plus derive the satisfaction of passing on your experience? By [becoming a mentor](#) to a student member or early career engineer. Early career engineers eligible for ementoring have been out of school for 5 years or less.

Go to: http://www.asme.org/Jobs/Mentoring/Call_Mentors.cfm for more information.